

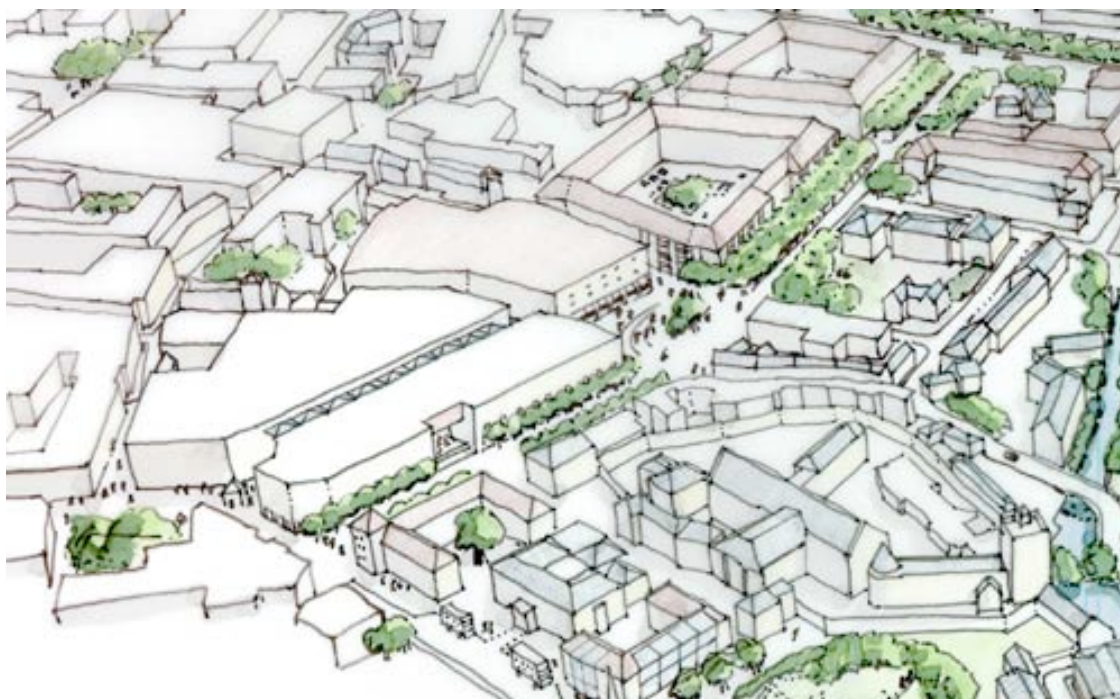

## Ideas for the Westgate Centre area by a local urban design practitioner.

These plans and perspectives come from 'The West Central Oxford Urban Design Strategy' produced by [Roger Evans Associates](#) for Oxford City Council in 1999, and are reproduced here with their kind permission.



View looking South over former prison site: Proposed redevelopment scheme for the Westgate Centre and a new City Square.

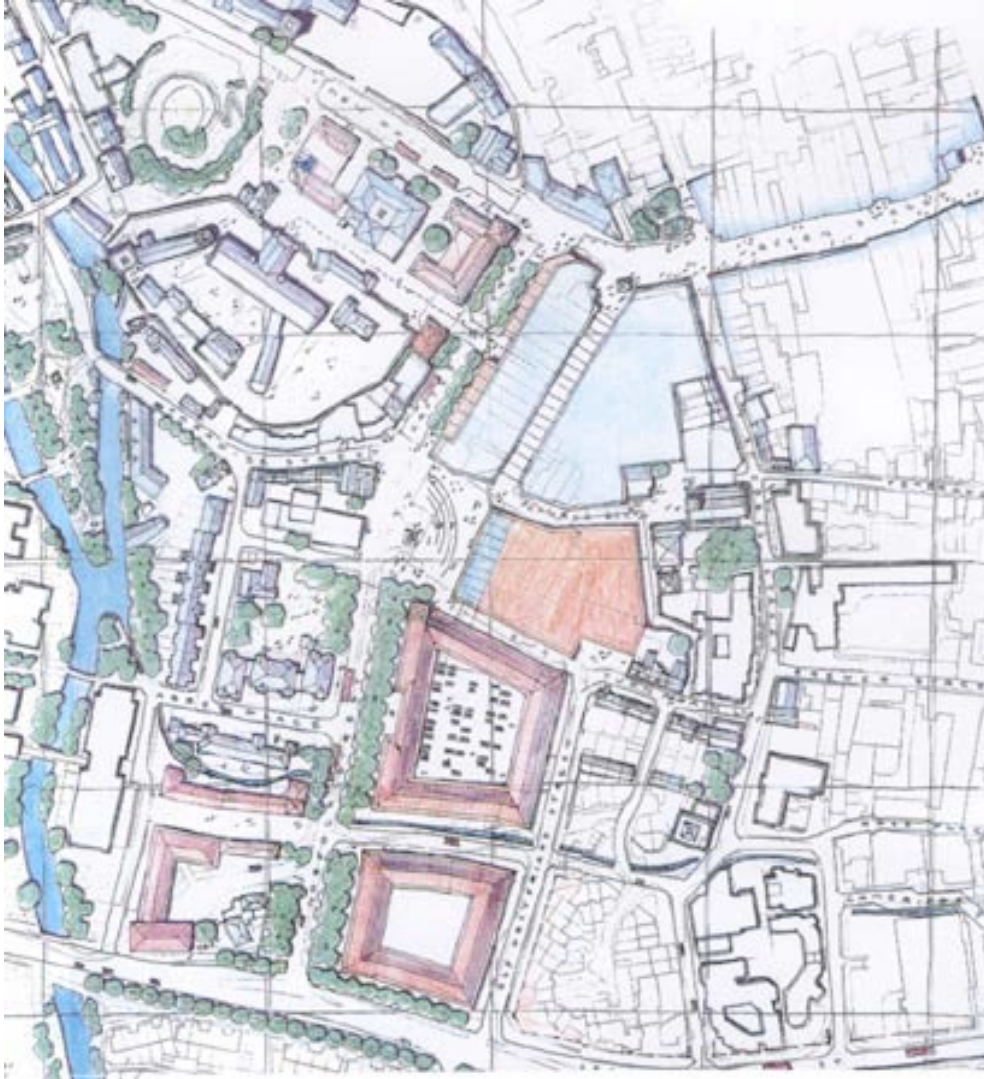

This is an illustrative plan showing the above scheme around the Westgate site.

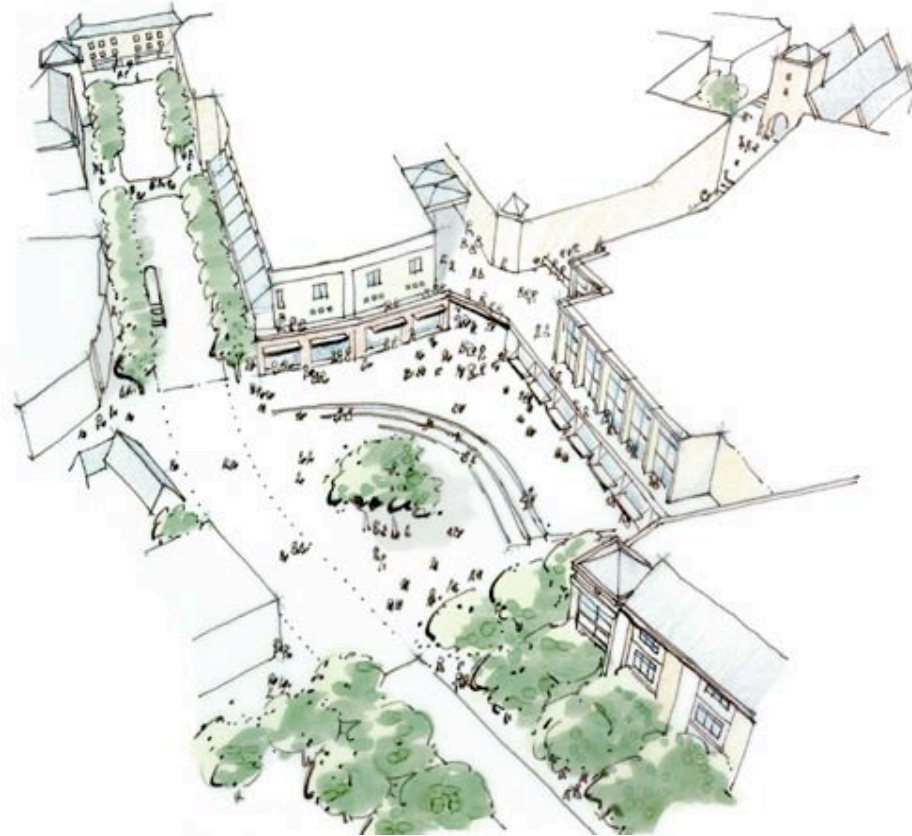

Birds-eye view looking north up Castle Street over proposed city square at the junction of Norfolk Street and Old Greyfriars Street. Note zone 'A' retail on two levels, return shopping frontage to Castle Street, and the re-instatement of Church Lane leading to St. Ebbes Church.